

MX300 Series

Parts List

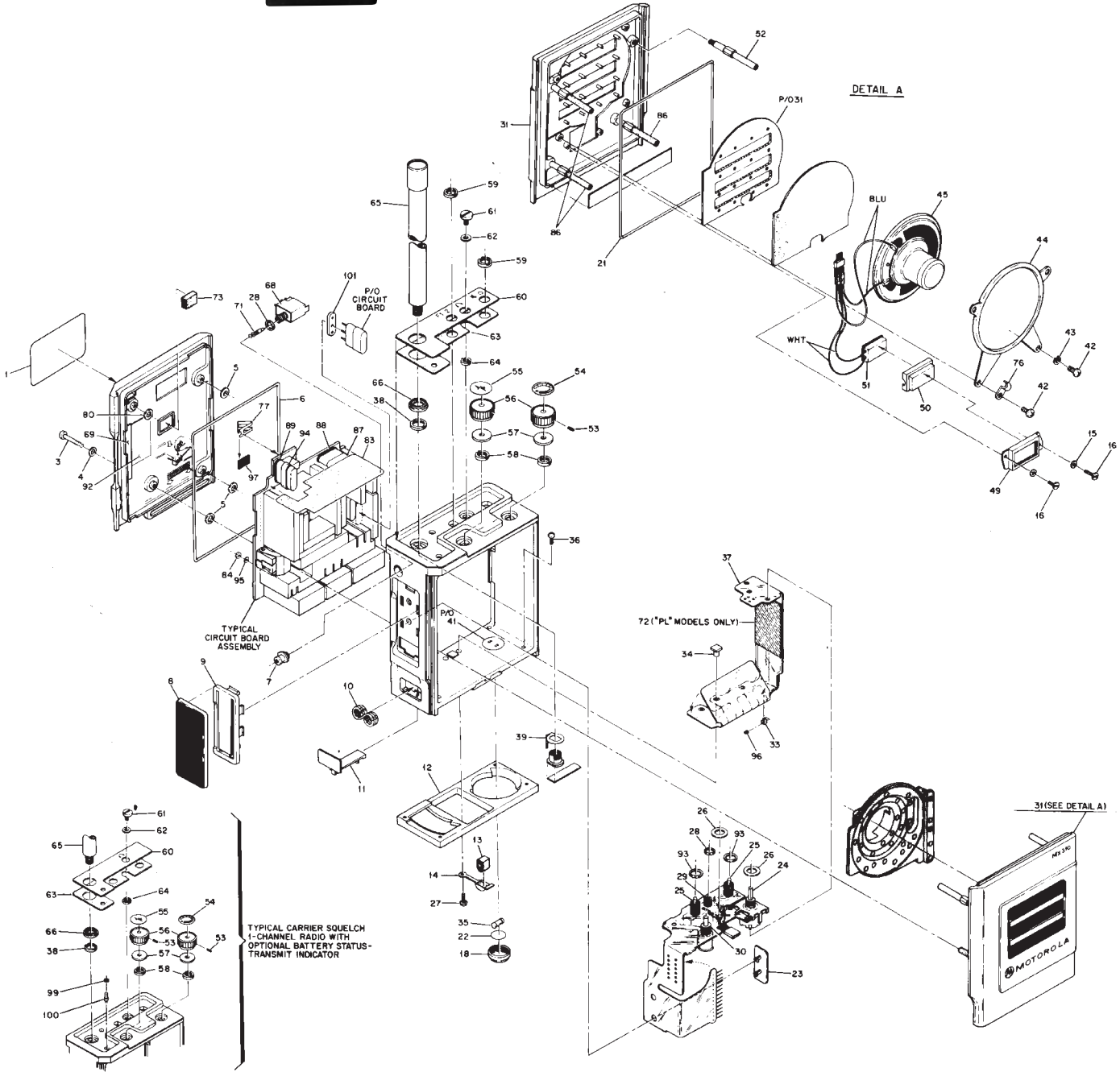

Replacement parts are no longer available

MX300 Series*Parts List***MX 310, H23AAB, H24AAB**

REF. NO.	PART NO.	DESCRIPTION	REF. NO.	PART NO.	DESCRIPTION
-------------	----------	-------------	-------------	----------	-------------

***Cancelled Product MX300:
Aftermarket support criteria has
been met for spare parts. Items
are no longer available.***

MX300 Series

*Portable
Accessories*

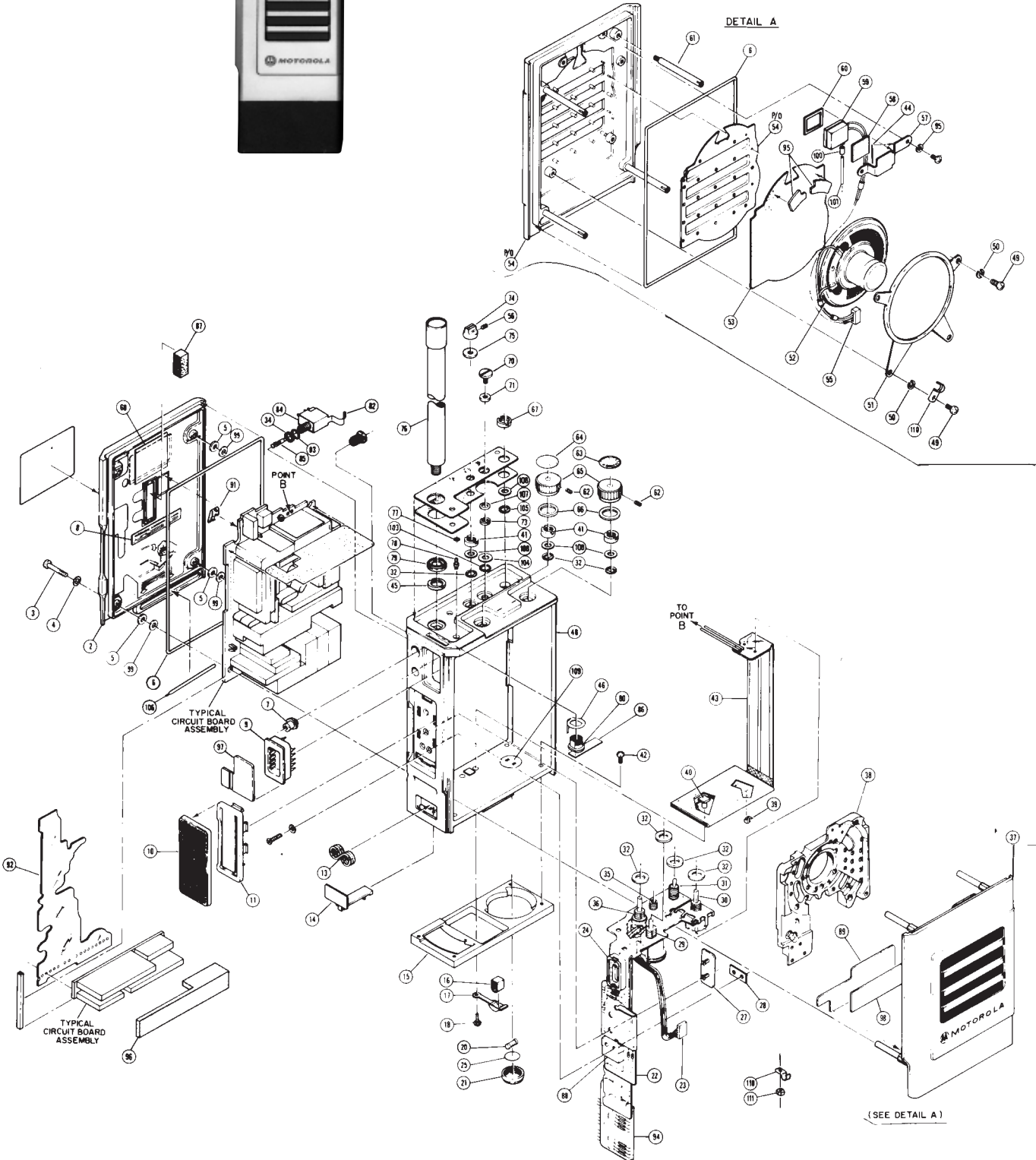

Replacement parts are no longer available

MX300 Series*Parts List***MX320, MX330, MX340, MX350, MX,360, H23AAU, H24AAU, H33AAU, H43AAU, H44AAU**REF.
NO. PART NO. DESCRIPTIONREF.
NO. PART NO. DESCRIPTION

***Cancelled Product MX300:
Aftermarket support criteria has
been met for spare parts. Items
are no longer available.***

MX300 Series

Portable Accessories

Chargers

Single Unit Chargers

Single unit chargers are designed for desktop use and are capable of charging a battery on or off the radio. When the battery is fully charged, the charger automatically resets to a trickle charge rate. Rapid charge batteries must be charged in the rapid charge unit to attain the rapid charge rate. Visual indication is provided in the rapid charger when the battery is fully charged.

NLN8858A Single Unit,
1 Hour, Rapid Charger,
117 Volts

***NLN4038A** Single Unit,
1 Hour, Rapid Charger,
220 Volts

***NLN4036A** Single Unit,
14 Hour, Standard
Charger, 220 Volts



NLN8858A

Battery Maintenance System^{plus} (BMS^{plus})

Using interchangeable battery adapters (sold separately), the BMS^{plus} is capable of charging and discharging, analyzing, conditioning and cycle test on batteries; tracking battery voltage and capacity (mAh). The BMS^{plus} offers a 3 year warranty. Its easy-to-use design supports hundreds of 2-way, cellular, and camcorder batteries with printer port** (Serial-RS-232C port – uses female 9-pin to male 25-pin cable).

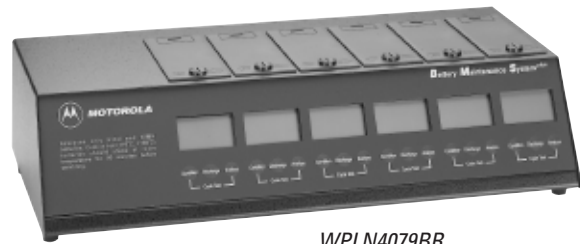

WPLN4079BR

WPLN4079BR Six-Station, 110V AC, 50/60 Hz

WPLN4080BR Six-Station, 230V AC, 50/60 Hz

NDN4005B Three-Station, 110V AC, 50/60 Hz

NDN4006B Three-Station, 230V AC, 50/60 Hz

BMS^{plus} Adapter

TDN9445A Standard Adapter, MX300

Optional Adapters

†**TDN9432A** Adapter, Universal Alligator Clip Lead

†**TDN9527A** Adapter, Universal Dip Switch

* Unit is supplied without line cord plug.

**Compatible with the STAR Micronics SP200 series printers, available from any STAR Micronics distributor, and other printers with STAR emulation.

† Universal adapters available as an option to accommodate all radio types.

MX300 Series

Portable Accessories

Battery Optimizing System II (BOS II)



WPLN4124AR

No other battery analyzer matches the speed, accuracy, and versatility of the Battery Optimizing System II. Ideal for large fleet, public safety, and all other users who rely on their battery performance. Now with increased power, more sophisticated programming options, and easier to use navigation paths, optimizing your batteries was never easier. Key features include:

- Support for NiCd, NiMH, Li-ion, and SLA batteries
- 100 watt power supply and programmable from 100 mA to 4 amps per station
- Interchangeable adapters accommodate all major brands
- Includes a variety of user programs and allows for customizable programming
- Proprietary recondition cycle restores NiCd and NiMH batteries
- Increased processing power and testing resolution – including a three minute Quicktest that measures the batteries State of Health (SoH)
- Printer output for reports and labels
- Three year warranty

WPLN4124AR BOS II, Four-Station, 100-240V AC (US line cord)

WPLN4125AR BOS II, Four-Station, 100-240V AC (UK/Euro line cords)

BOS II Adapters

RL-71181 Standard Adapter, MX300, 500-700 mAh

RL-71182 Standard Adapter, MX300, 1100-1400 mAh

RL-71183 Standard Adapter, MX300, 2000-2800 mAh

Optional Adapters

RL-70115 Adapter, Universal; services Li-ion

RL-70110 Adapter, Universal; service NiCd and NiMH

Audio Accessories

UHF Surveillance Accessories

NMN6092A
UHF Surveillance Accessory

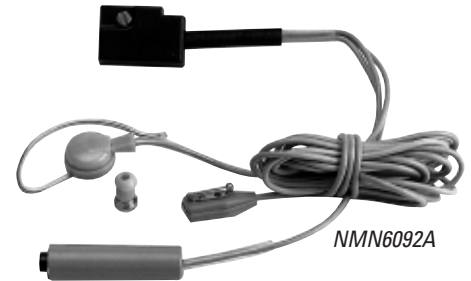

NMN6092A



NMN6070B



NMN6071B



NMN6072A

Remote Speaker/Microphones

Remote speaker/microphone allows user to talk and listen without removing radio from belt or carrying case. Ideal in high noise level areas. Straight and coil cord remote units have back clip for attachment to upper garment. Wired earpiece available for all models.

NMN6070B Remote Speaker Microphone Straight Cord with Clip Back

NMN6071B Remote Speaker Microphone Coil Cord with Clip Back

NMN6072A UHF Public Safety Microphone with High/Low Switch and PTT, order Velcro Patch and Antenna separately.

Antennas for NMN6072A

8505309N10 Heliflex, 404-430 MHz,

8505309N09 Heliflex, 440-470 MHz

8505309N11 Heliflex, 470-512 MHz

MX300 Series

Portable Accessories

Audio Accessories

Epaulet Strap

Black leather epaulet straps secure remote speaker microphones to epaulet of shirts or jackets and attach around cord. Allows reliable communications in hostile environments with Velcro or Clip style strap.

RLN4294A Epaulet Strap, Velcro

RLN4295A Epaulet Strap, Small Clip



Velcro Patch

NLN8410A Velcro Patch Pin Attachment, (for NMN6072A Microphone)

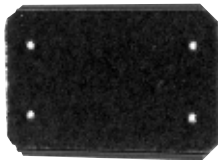

Earpiece

5005178K01 Earpiece, Without Volume Control

5080332A41 Plastic Insert for Earpiece



Audio Accessories

Headset/Microphones

Maintain portable two-way communications in high ambient noise areas with noise cancelling accessories. Both weatherproof models can be worn with or without a safety type helmet.



NMN6065A

Noise Canceling Headset/Microphone with Cup Microphone

NMN6064A

Noise Canceling Headset/Microphone with Boom Microphone



NKN6207A Adapter Kit

(required for noise cancelling headsets)

MX300 Series

Portable Accessories

Audio Accessories

Ear Mics

Single unit microphone and speaker worn in the ear. Eliminates the need for handheld microphones or conventional headsets. Compact, rugged design allows use under hearing protectors and protective clothing. Order cable separately.

RMN4001B Ear Mic, EM200

0180359A41 Interface Cable for MX300

0180359A51 Optional PTT Ring Switch for RMN4001A only

0180356B97 Optional PTT Ring Switch for RMN4001B only



RMN4001B



0180359A51

Cost effective alternative to the EM200, the EM150 operates the same but includes hardwired interface cable. (PTT ring switch is not compatible with this unit)

RMN4007A Ear Mic, EM150



RMN4007A

Carrying Accessories

Carrying Cases

Standard black leather carrying cases with snap-on/off perforated full covers provide protection yet permit clear audio. T-strap covers permit easy access to all controls. The over-the-shoulder adjustable sturdy black nylon carrying strap snaps onto the belt loop case and provides a convenient way to wear a radio. Swivel carrying cases attach to belt loop attachment by inverting radio. Radio swings freely on belt loop attachment, adjusting to body movements.



1505333D07

MX310 Series Standard

1505333D03 Carrying Case for Medium Capacity Battery

1505333D05 Carrying Case for Medium High Capacity Battery

1505333D07 Carrying Case for High Capacity Battery

MX320 Series Standard

1505333D03 Carrying Case for Light and Medium Capacity Battery, with 2-1/2" Belt Loop

1505333D04 Carrying Case for Medium High Capacity Battery, with 2-1/2" Belt Loop

1505333D06 Carrying Case for High Capacity Battery and/or Non-Rechargeable Battery, with 2-1/2" Belt Loop

1505333D08 Carrying Case for Ultra-High Capacity Battery, with 2-1/2" Belt Loop



1505333D03

MX300 Series

Portable Accessories

Carrying Accessories

MX320 Series Swivel

NLN4121A Carrying Case for High Capacity Battery and/or Non-Rechargeable Battery, with 3" Belt Loop

NLN4123A Carrying Case for Ultra-High Capacity Battery, with 3" Belt Loop

MX340 Series Swivel

NLN4121A Carrying Case for Med-High Capacity Battery, with 3" Belt Loop

NLN4123A Carrying Case for High Capacity and/or Non-Rechargeable Battery, with 3" Belt Loop

MX330 Series Standard

1505333D03 Carrying Case for Light Capacity Battery, with 2-1/2" Belt Loop

1505333D04 Carrying Case for Medium Capacity Battery, with 2-1/2" Belt Loop

1505333D05 Carrying Case for Med-Light Capacity Battery, with 2-1/2" Belt Loop

1505333D07 Carrying Case for High Capacity Battery and/or Non-Rechargeable Battery, with 2-1/2" Belt Loop

1505333D09 Carrying Case for Ultra-High Capacity Battery, with 2-1/2" Belt Loop

MX350 Series Standard

1505333D05 Carrying Case for Light Capacity Battery, with 2-1/2" Belt Loop

1505333D06 Carrying Case for Medium Capacity Battery, with 2-1/2" Belt Loop

1505333D08 Carrying Case for Med-High Capacity and/or Non-Rechargeable Battery, with 2-1/2" Belt Loop

1505333D9 Carrying Case for High Capacity Battery, with 2-1/2" Belt Loop

1505333D10 Carrying Case for Ultra-High Capacity Battery, with 2-1/2" Belt Loop



1505333D07



NLN4121A



1505333D10

MX340 Series Standard

1505333D04 Carrying Case for Light and Medium Capacity Battery, with 2-1/2" Belt Loop

1505333D06 Carrying Case for Med-High Capacity and/or Non-Rechargeable Battery, with 2-1/2" Belt Loop

1505333D08 Carrying Case for High Capacity and/or Non-Rechargeable Battery, with 2-1/2" Belt Loop

1505333D09 Carrying Case for Ultra-High Capacity Battery, with 2-1/2" Belt Loop



1505333D08

MX300 Series

Portable Accessories

Carrying Accessories

MX350 Series Swivel

NLN4121A Carrying Case for Medium Capacity Battery, with 3" Belt Loop

NLN4123A Carrying Case for Med-High Capacity and/or Non-Rechargeable Battery, with 3" Belt Loop

MX360 Series Standard

1505333D07 Carrying Case for Light and Medium Capacity Battery, with 2-1/2" Belt Loop

1505333D09 Carrying Case for Med-High Capacity Battery, with 2-1/2" Belt Loop

1505333D10 Carrying Case for High Capacity and/or Non-Rechargeable Battery, with 2-1/2" Belt Loop

1505333D11 Carrying Case for Ultra-High Capacity Battery, with 2-1/2" Belt Loop



NLN4125A



1505333D11

Carrying Accessories

Cover

1505332D01 Cover for Carrying Case



1505332D01

Carry Holders

NLN8862B Carry Holder, Swivel. Belt loop not included.

NLN8861B Carry Holder, Belt Loop



NLN8862B

Carrying Strap

NTN5243A 60" Carrying Strap



NTN5243A

UHF and VHF 3" Belt Clip Back Cover

NLN7320A MX360



NLN7320A

T-Strap

4205360D01 For All Carrying Cases



Belt

4200865599 1-3/4" Wide Leather Belt, for all models

4205857B01 2" Spare Belt Loop, for swivel cases

4200865599

MX300 Series



Mobile Op Accessories, Antennas

Mobile Operation Accessories

All MX300 series portables are universal converta-com. Palm-type mobile microphone with coil cord and push-to-talk switch provides true mobile transmission key lock, power cables, push button release for portable are included.

Converta-Com Console Extenders

1505716D02 Converta-Com Console 1.5" Extender Pocket (Standard)



TMN6054A

Microphone

TMN6054A
Remote Microphone

Portable Antennas

Heliflex

Each antenna is tested and tuned to give maximum power and performance. Antenna's connector is color coded indicating frequency. These antennas are ideal for VHF and UHF MX300 radios because of their rugged and flexible design.

8505355K03 403-430 MHz
for use on Public Safety
Speaker/Microphone

8505355K04 440-470 MHz
for use on Public Safety
Speaker/Microphone

8505309N11 470-512 MHz
for use on Public Safety
Speaker/Microphone



8505355K03



8505355K04

Portable Antennas

8505816K01 136-150 MHz
Injection Molded

8505816K21 150-162 MHz
Injection Molded

8505816K23 162-174 MHz
Injection Molded

8505816K24 403-433 MHz
Injection Molded

8505816K25 438-470 MHz
Injection Molded

8505816K26 470-512 MHz
Injection Molded

8505491J02 150-162 MHz
PVC Dip Coated

8505491J03 162-174 MHz
PVC Dip Coated

8505491J04 403-440 MHz
PVC Dip Coated

8505491J05 440-470 MHz
PVC Dip Coated

8505491J06 470-512 MHz
PVC Dip Coated



8505816K01



8505816K23



8505491J05

Flexible

Slightly longer than helical antenna and provides better radiation characteristics.

8505247K06 403-512 MHz, Molded

NAF4000B 806-870 MHz, Molded

8505268F01 403-512 MHz,
PVC Dip Coated



8505247K06



NAF4000B

MX300 Series

Batteries, Service Tools & Aids, Manuals

Portable Batteries

Nickel-Cadmium Premium

Part Number: **NLN5860D**
 Volts: 7.5
 Avg. mAh: 1400
 Height: 3-2/16"
 Intrinsically Safe: Yes

Service Tools

6682186E01 Tuning Tool

6605168F01 Wrench, Antenna
 Bushing Nut and Fuse Cap
 (800 MHz only)



Service Aids

Radio Test Cable

Used with RTX4005 portable radio test set for transmitter, receiver alignment and performance checks.

RTK4021A Test Cable



RF Adapter Cable

SKN6028A RF Adapter Cable, connects to radio jack, other end terminated with type BNC male.



Service Manuals

406-512 MHz

- 6881007C06** Models H24/H34AAU 1W & 2W "A" Models Service Manual
- 6881013C75** Models H44AAU 5W "A" Models Service Manual
- 6881007C10** Models H24/H34/H44AAU "A" Models Theory/Maintenance Manual
- 6881007C55** Models H24/H34/H44AAU Operating Instructions
- 6881009C40** Models H24H/34AAU1140A, 1160A, 1180A, 3140A, 3160A, 3180A, 6140A, 6160A, 6180A Service Manual
- 6881013C75** Models H44AAU1140A, 1160A, 1180A, 3140A, 3160A, 3180A, 6140A, 6160A, 6180A Service Manual

806-850 MHz

- 6881007C55** Models H35AAU Operating Instructions
- 6881015C85** Models H35AAU Service Manual

MX300 Digital Voice Protection

- 6881015C40** Models H23/H33/43AXU, and H24/34/44 Instruction Manual

MX300 Series Converta-Com

136-174 MHz, 406-512 MHz

- 6881010C75** Model N1244A Mobile Radio Console Instruction Manual
- 6881010C80** Model N1244R Mobile Radio Console Operating Instructions

MX300 Series Power Amplifiers

136-174 MHz, 406-512 MHz

- 6881013C30** Model N1254A 60W Power Amplifier for use with N1244A Converta-Com Consoles, Instruction Manual

Miscellaneous

- 6881030C65** MDC-600, MDC-1200, Modat, and Select 5 Signaling Options Service Manual
- 6881106C06** Routine Maintenance Procedures Manual

Over 7 million customers have made MyRadioMall.com America's #1 choice when it comes to dependable and reliable Motorola Communications at fantastic prices.

We are now celebrating our 12th year of online service and the best is yet to come.



Advanced Radio Systems, Inc
8726 NW 26 Street #6
Miami, Florida 33172
Voice Numbers: 305-884-1795
Toll Free: 1-866-900-Mall (6255)
Fax Number: 305-884-1985

12/25/2006